

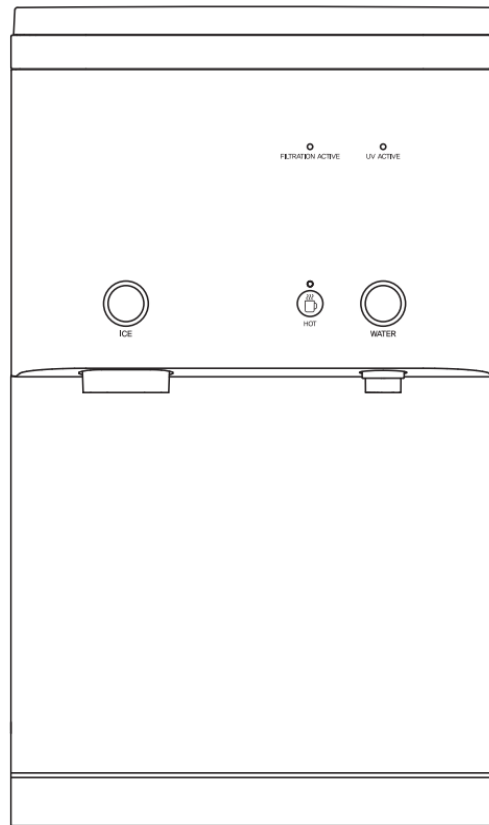







DISPLAY & CONTROL PANEL



 FILTRATION ACTIVE	FILTRATION ACTIVE	FILTRATION ACTIVE LED is on when the water is filtered.
 UV ACTIVE	UV ACTIVE	UV ACTIVE LED is on when the UV LED is activated. (2x UV LED in ICE TANK)
 ICE	ICE LED	ICE LED will be on when the ice is ready to be served, and blink while dispensing.
	ICE DISPENSE BUTTON	Push the button to dispense ice.
 HOT	HOT WATER LED	HOT WATER LED is on when the hot water is selected. (Red)
	HOT WATER SELECT BUTTON	Push the button to select hot water.
 WATER	WATER LED	WATER LED will be on when the water is ready to be served, and blink while dispensing.
	WATER DISPENSE BUTTON	Push the button to dispense ambient/hot water.
	ICE DISPENSE SPOUT	Ice is dispensed from ICE DISPENSE SPOUT.
	WATER DISPENSE SPOUT	Water is dispensed from WATER DISPENSE SPOUT.

OPERATING INSTRUCTIONS

The below pictures show the front user interface (UI) and control panel for the *i16 Water Treatment System*.

For Ice: Press the “Ice Dispense” button. While holding the button, the Ice LED will blink, and ice will dispense. Release to end.

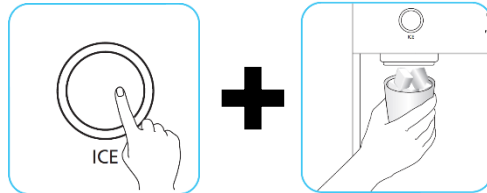

For Hot Water: Press the “Hot Water Select” button, then press and hold the “Water Dispense” button, and water will begin to dispense. While holding the button, the Water LED will blink. Release to end.

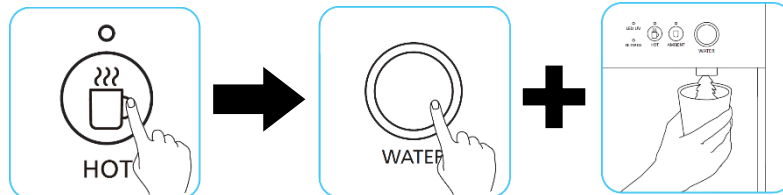

For Ambient Water: Press the and hold the “Water Dispense” button, and water will begin to dispense. While holding the button, the Water LED will blink. Release to end.

